

Frame Glazing



Installation guide

Removing Frame Beads (no glazing)

Removing the Beads ready for glazing is fairly simple when there is no glass unit installed. The Beads have been held in place with foam packing pieces.

As you remove the Beads it is important to remember the positions they were removed from as they should be installed in the same location you removed them from.

Remove the vertical Beads first, as these will have sculpted edges that fit over the top of the horizontal Beads, which are square ended. The Horizontal Beads are the first set to install when you start glazing, effectively working in the reverse order of their removal.

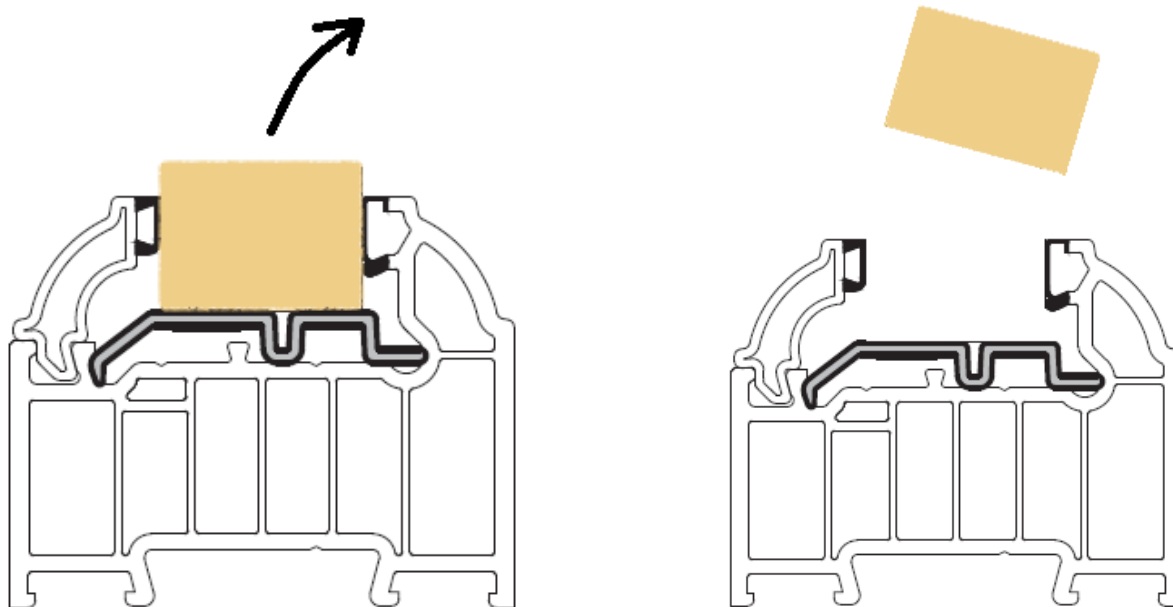

First remove the foam packers, these are only there to hold the Beading in place during transport, and can be discarded.

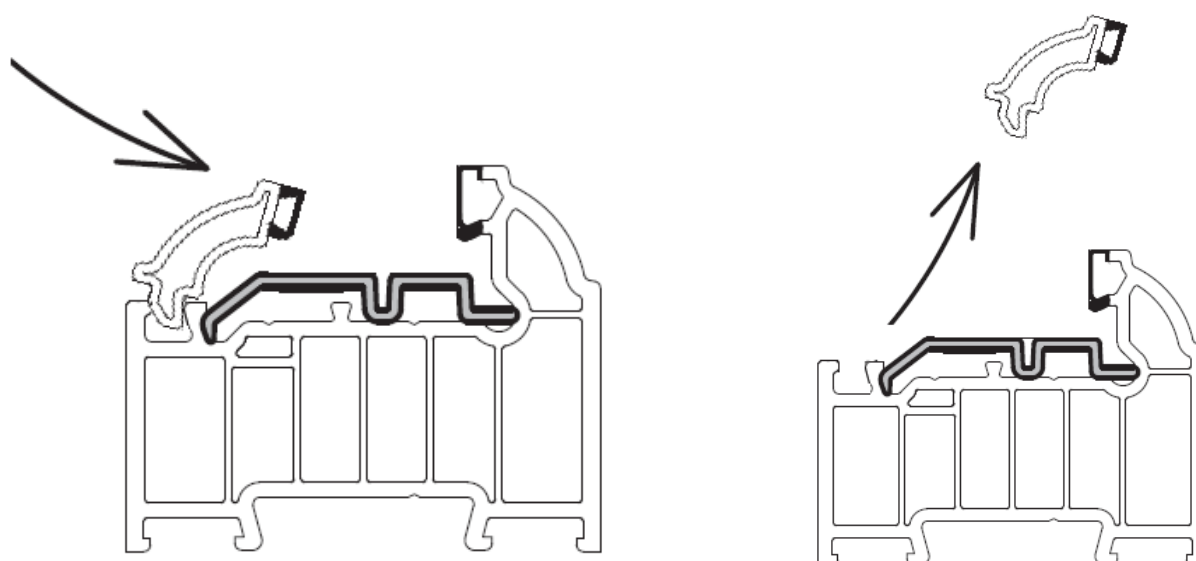

To remove the Beads, firmly push them forward towards the inside of the frame, as the Bead rotates forward it should pop out of position. Start from the middle of the bead.

Tools you will need



You will need a rubber or nylon hammer to install the frame glazing and beading (not supplied) along with a selection of supplied plastic Glazing Packers.

Be careful to make sure you only strike the frame beading and not the glazing unit.
Appropriate PPE such as gloves and eye protection should be worn.

Fitting the glazing



Identify the correct glazing unit for the frame. Push firmly in place ready to pack the glazing unit and then fit the beading.

Glazing Platform

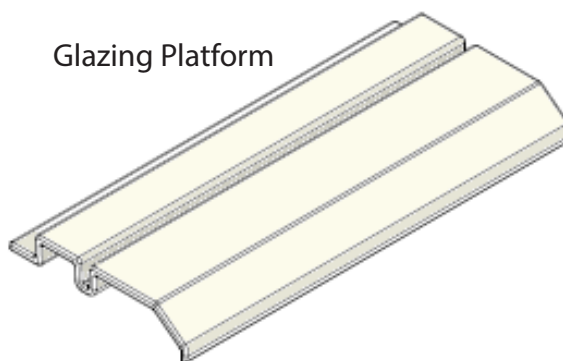

Next you will need to correctly pack each glazing unit. You will notice that Glazing Platforms have already been pre installed in our factory in their correct positions.



The glazing unit needs to be installed ensuring a tight fit against the glazing platforms. Additional glazing packers can be used to lift the glazing unit to the required position, and to allow you to equally position the seals around the edge of the frame.

For details about the correct general position of glazing packers, see the diagrams on the next page showing the most popular styles of windows in our conservatories.

For side hung opening windows, you will need to 'toe & heel' the glass unit, packing it horizontally. The bottom packers should always be the hinge side, the top packers should always be on the handle side.

Correct Glazing Platform & Packer positions

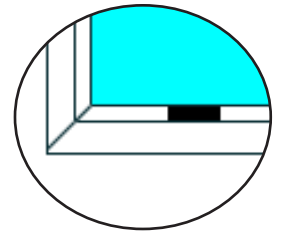
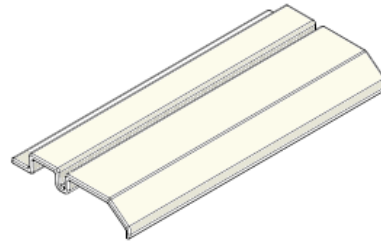
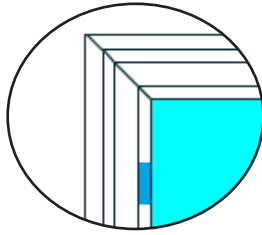

Glazing Packers. Positions in the diagrams shown using blue rectangles as above.

Glazing Platforms. Positions in the diagrams shown using black rectangles as above.

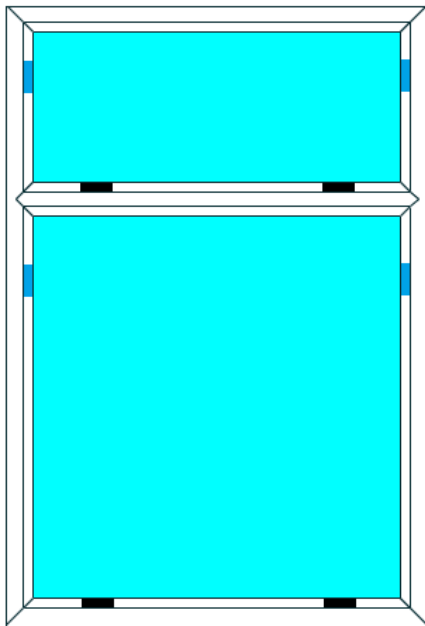

Double Fixed Frame

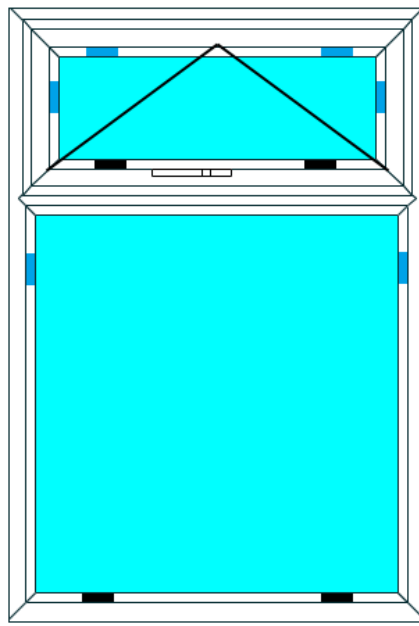

Top Opener

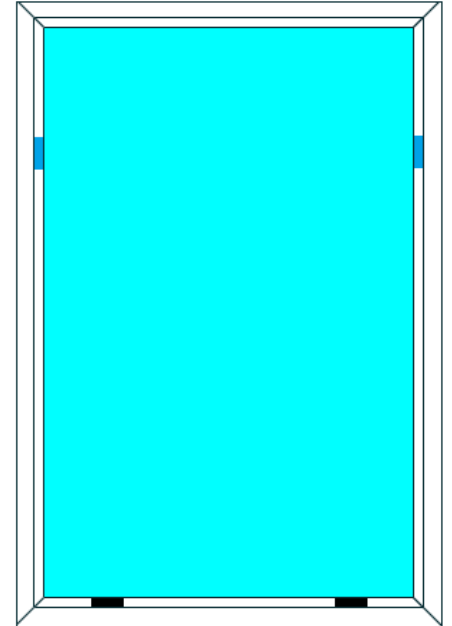

Fixed Frame

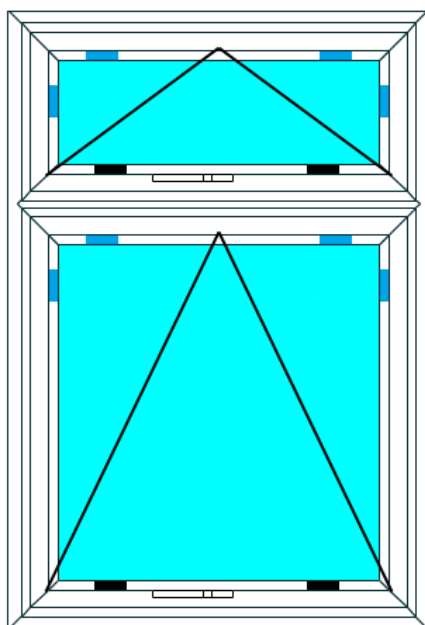

Double Top Opener

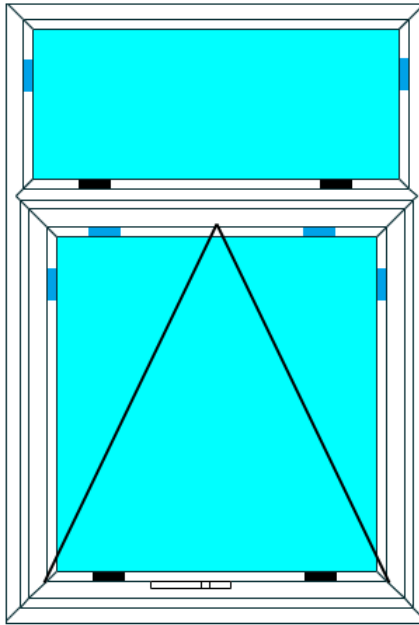

Bottom Push Out

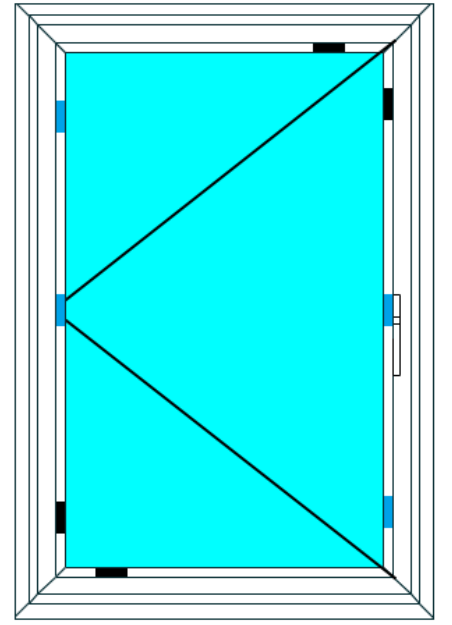

Side Hung Frame

Fitting the Beading

Start with the horizontal square ended Glazing Beads.



Start in one corner and firmly knock the Glazing Bead in, working from one side to the other.

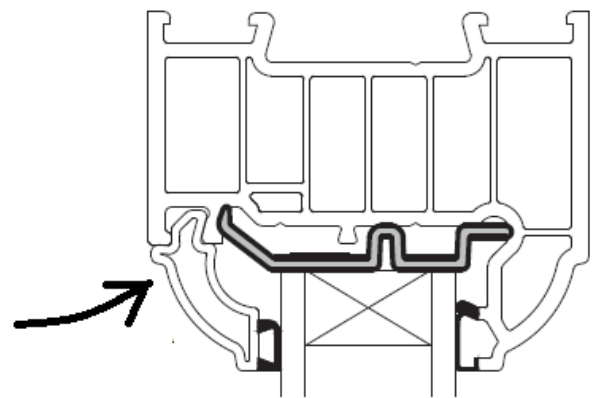

The diagram to the above right shows the part of the Frame Bead you should aim to strike.



To fit the vertical sculpted Beads, you will need to:

(1) bend the Bead and push each end into the corners of the frame, creating a 'bow' shape, then firmly knock these in place before working into the centre of the Glazing Bead (2)

Make sure each Glazing Bead is tight up to the horizontal Beads.

Repeat this process for all Glazing Units.

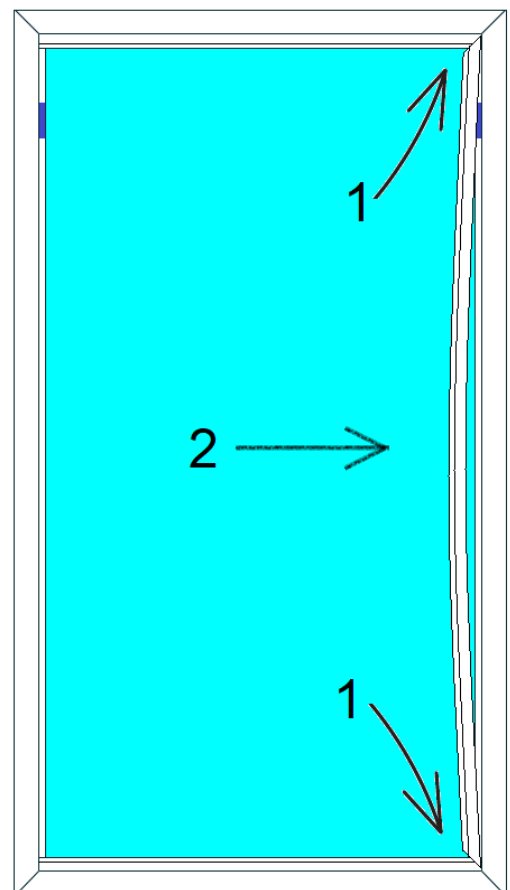

Removing Frame Beads (Glazed frames)

Once your frames are glazed there shouldn't be any need to remove the beads. However, should you need to do so for any reason, please use the instruction below.

You will need a Glazing Knife or Wide Bladed Putty Knife to remove the beads. Insert the blade of the knife between the frame and the edge of the bead as shown in the diagram on the right.

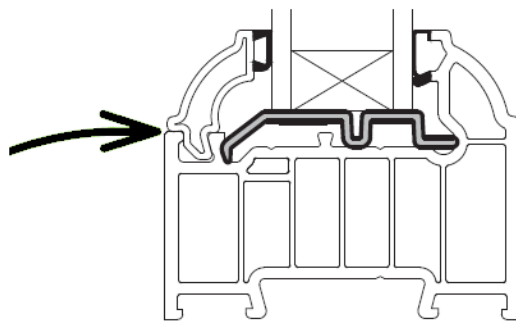

Start in the middle of the bead, pushing upwards with the knife, and gradually work across the bead.

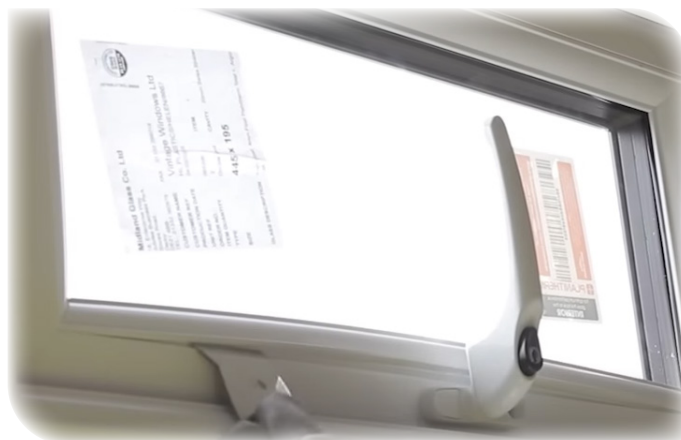
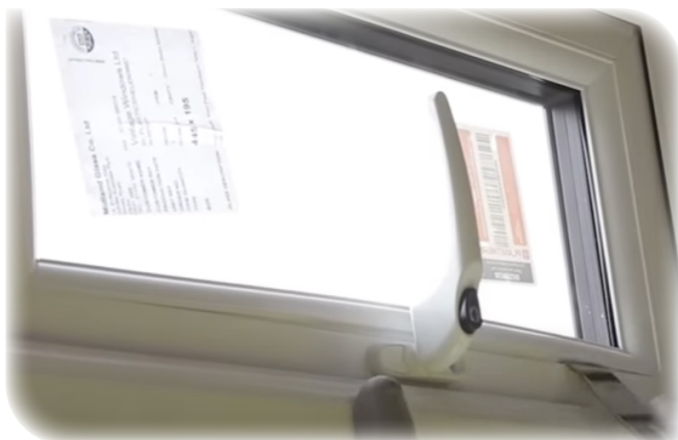

As you have worked across one side of the bead, move from the middle to the opposite side of the bead.

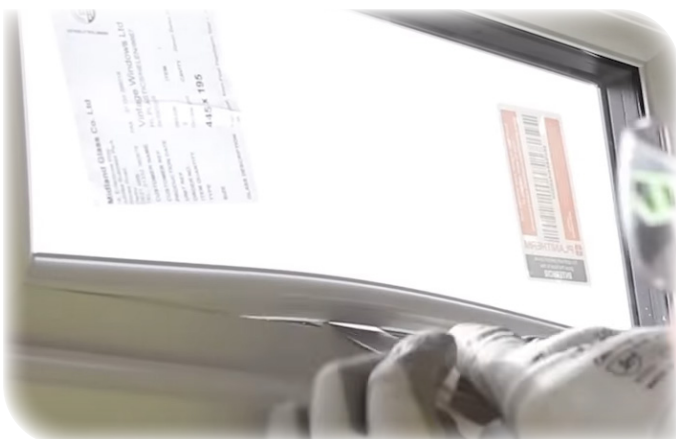

Repeat this process until the bottom of the bead is visible. Insert the knife under the bead, and push upwards until you can pull the Beading out of its channel.